



Amicalola Falls Lodge and Conference Center is located within 2,050 acre Amicalola Falls State Park in North Georgia, 15 miles northwest of Dawsonville, 18 miles west of Dahlonega and 54 miles from Atlanta's perimeter I-285.

In the midst of the Chattahoochee National Forest, the lodge and park are a beautiful setting for group meetings, family gatherings and conferences. Within walking distance from the lodge is the 729-foot falls that the Cherokee Indians named Amicalola, meaning, "tumbling waters". Amicalola Falls Conference Center is surrounded by natural beauty and creates an atmosphere perfect for any retreat or getaway.

At Amicalola Falls we strive for excellence and believe that the formula for a successful meeting or social function must include an invigorating atmosphere, complimented by informative and friendly service. We hope you make Amicalola Falls State Park and Conference Center your next Great Georgia Getaway!

From Atlanta: Take GA 400 to Highway 53 and go west. After passing through Dawsonville, go north on GA 183 and then east on GA 52 to the park.

OR, go north on I-75, I-575, and GA 5 to Jasper. In Jasper, follow the signs to GA 136 and take it to GA 183. Go north on 183, then east on GA 52 to the park.

From Chattanooga (78 miles): Take I-75 south to Dalton, exit 136. Go east on GA 52 through Chatsworth and Ellijay to the park.

All of above cases: Entrance to the park is on left, about 1 mile past Burt's Pumpkin Farm. Amicalola Falls State Park, 418 Amicalola Falls Lodge Road, Dawsonville, Georgia, 30534. (You can use this address to get another map from Mapquest if desired.)

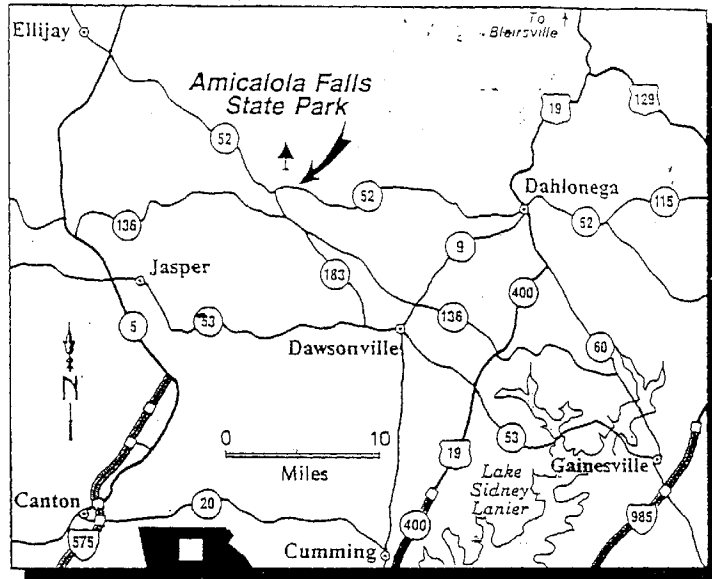

Located 15 miles northwest of Dawsonville. Take Ga. Hwy. 53 west out of Dawsonville, then Ga. Hwy. 183 to Ga. Hwy. 52 east.

NEARBY ATTRACTIONS

- Dahlonega Gold Museum
- Chief Vann House
- New Echota Cherokee Capital
- Vogel State Park
- Alpine Village of Helen
- Bill Elliott Museum
- Unicoi State Park and Lodge
- Appalachian Trail
- Chieftains Trail
- Fort Mountain State Park
- Ellijay Apple Country
- Many Area Waterfalls
- Burt's Pumpkin Farm
- North Georgia Premium Outlet Mall

FACILITIES, ACTIVITIES AND ATTRACTIONS

FACILITIES:

LODGE: Four story, 57-room lodge with Mountain View from all guestroom. Full amenities.

COTTAGES: 14 cottages, 1 – 3 bedroom, set on the mountains for a panoramic view or in the woods along a creek. Fully equipped with kitchen, utensils and linens.

CAMPING: 20 campsites for tents or trailers (trailers limited to 17 feet due to steep incline). Comfort station offers hot showers, flush toilets and laundry facilities.

DINING: The Maple Restaurant in the lodge seats 160 and offers buffet and a la carte dining at breakfast, lunch and dinner to lodge guests and the public. The restaurant features a Spectacular Mountain View from the glass-walled dining room.

ROPES COURSE: Amicalola has a great group ropes course for all your team building needs.

ACTIVITIES:

PICNICKING: 78 open picnic tables, first-come first-served. Five covered picnic pavilions, which may be reserved through the sales office.

HIKING: Nearly 3 miles of trails in the park, plus the 8.5-mile approach trail to the Appalachian Trail.

FISHING: Stocked stream and Reflection Pool for trout fishing in season. Persons age 16 and older must have a valid fishing license and trout stamp.

OTHER PARK ACTIVITIES: Volleyball, playgrounds and visitor center displays.

PROGRAMMING: The Programming Department offers a variety of unique and diversified educational, recreational, cultural, leadership-initiative and team building programs throughout the year. Most programs are free to the public and offered to park guests on a daily basis.

Programs and fees may vary. Programming can be coordinated with the sales office for your group at a charge. Some of our more popular programs to choose from are listed below:

<u>Environmental Education</u>	<u>Leadership & Team Building</u>	<u>Recreation</u>	<u>Living History</u>
Interpretive Hikes	Spider Web	Hayride	Native Americans
Snakes Alive	The Wall	Campfire	Gold Fever
Birds of Prey	Blind Polygon	Hoe-down	
Furry Forest Fellowes	The Meuse		
The Bear Facts			

AREA ATTRACTIONS:

- (1) North Georgia Premium Outlet Mall (17 mi. near Dawsonville)
- (2) Ellijay Apple Country
- (3) Burt's Pumpkin Farm
- (4) Many Area Waterfalls
- (5) Alpine Village of Helen (45 mi.)
- (6) Appalachian Trail (8.5 mile approach trail begins in the park)
- (7) Bill Elliott Showroom and Racing Museum
- (8) Chattahoochee National Forest (adjacent to park)
- (9) Dahlonega Gold Museum State Historic Site (18 mi.)
- (10) Etowah Indian Mounds State Historic Site (55 mi. near Cartersville)
- (11) Kennesaw Mountain National Battlefield Park (65 mi. near Marietta)
- (12) Lake Allatoona (50 mi. near Canton)
- (13) Lake Lanier (19 mi. near Dawsonville)
- (14) Tate House (25 mi. near Tate)
- (15) Red Top Mountain State Park (50 mi. near Cartersville)
- (16) Unicoi State Park (50 mi. near Helen)Chief Vann House State Historic Site (46 mi. near Chatsworth)

Amicalola Falls Meeting Space Capacity Chart

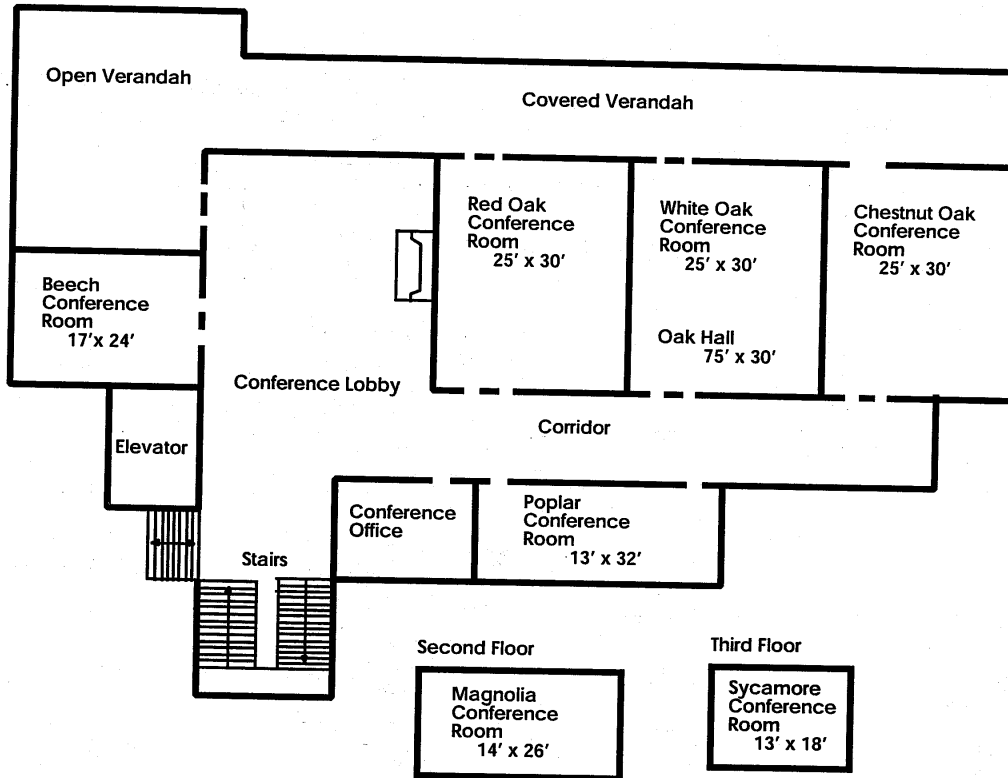

Meeting Room	Classroom	Theatre	Conference	U-Shape	Hollow-Square	Reception	Banquet
Oak Hall	110	200	70	75	85	250	150
Red Oak	40	70	20	25	28	70	40
White Oak	40	70	20	25	28	70	40
Chestnut Oak	40	70	20	25	28	70	40
Poplar	22	40	20	20	20	40	30
Beech	22	40	16	20	20	45	30
Sycamore	N/A	N/A	6	N/A	N/A	N/A	N/A
Magnolia	16	40	12	16	14	40	N/A